

Wing Ribs 1/32" thick;
1/16" depth
6 lbs/ft³ balsa
AB-grain

3.875

Wing covered with plastic film

7.875
.25 Wingtips Washout 1/4" Both sides

Wing Washout Fixture used when building wing to washout tips at trailing edge.

Wing Frame 1/16" sq. balsa
6 lbs/ft³ AB-Grain

4.5 to 5 Lb/ft³ C-Grain Balsa

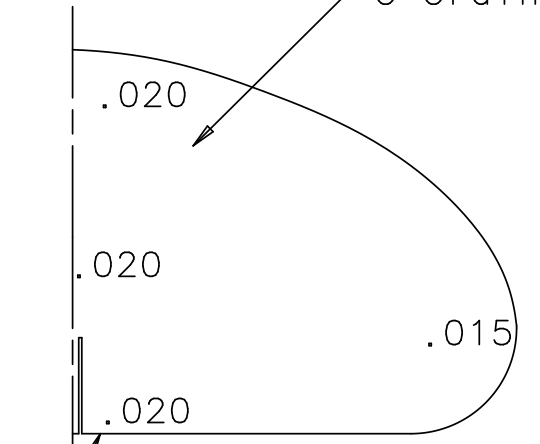

Bend both sides of elevator up 1/8"

Offset Rudder Trailing Edge .015" for left turn

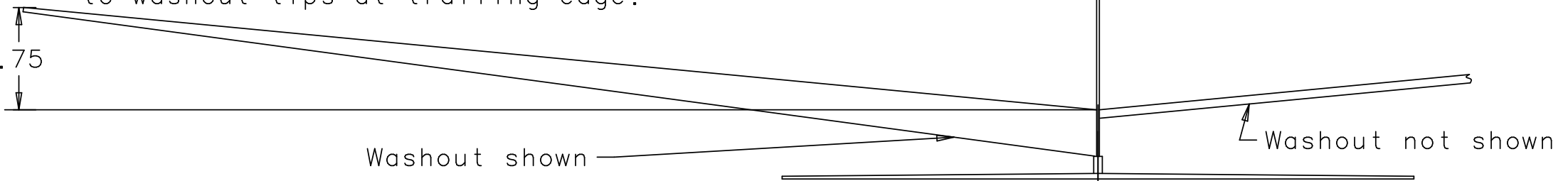

Washout shown

Washout not shown

No Stab Tilt

4.5 to 5 Lb/ft³ C-Grain Balsa

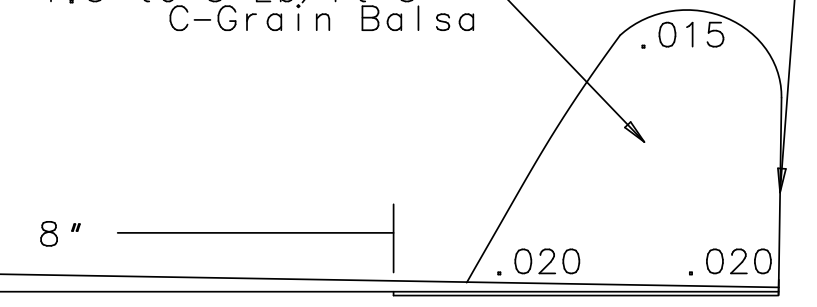

.062 Add Clay to trim glider

1/16" sq. post to mount wing to fuse

6.0

.125

8"

Fuse 1/16" wide;
6 lbs/ft³ Balsa wood
C-Grain

Weight Chart

Elevator	.2g
Rudder	.05g
Clay	.3g
Fuse	.4g
Wing	.55g
Total	1.5g

SO-BLG
Trail Event -per rules 2006
Design and drawn by Kurt Krempetz

